

MODEL **RS**

INCREMENTAL ENCODER

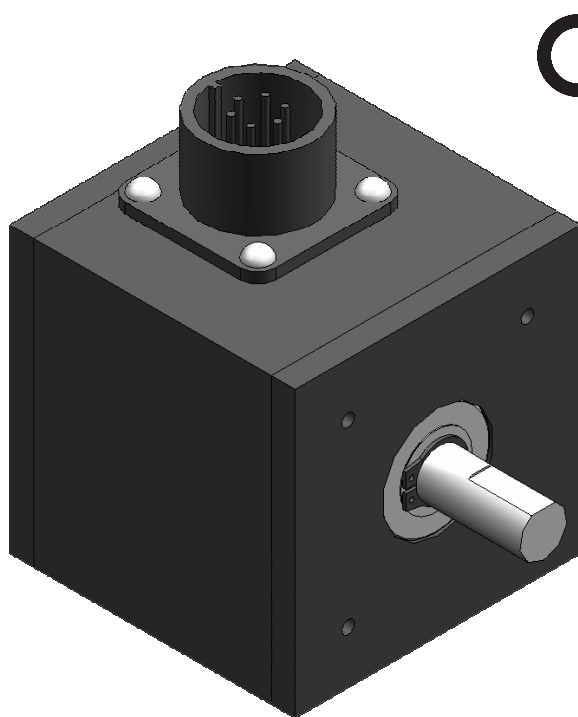

- 1/4", 5/16", 3/8", and 1/2" Shaft Diameters
- Double ended shaft option
- Heavy duty bearings option
- Hollow Shaft Available - see Model HRS
- Programmable Model - see Model RS-P
- Exclusive "Anti-Jitter" option for Material Handling applications
- 1 to 1200 pulses per revolution (ppr)
- Single, quadrature, and index outputs
- Dual or Triple output models with different ppr on each output
- Short circuit / ESD protection available
- Custom models available

2 1/4" Standard Cube Style Encoder

The Photocraft Model RS is an optical shaft encoder in a standard 2 1/4" cube shaped housing that is electrically and physically interchangeable with most cube style encoders on the market.

The model RS converts shaft rotation into square wave output pulses to provide an accurate means of digitizing position, rate or direction of rotation. Output pulses are generated when an internal code disk mounted on the shaft and having the specified output pattern is read by 1, 2, or 3 opto-sensors depending on the number of outputs required. The matched LED and opto-sensor pairs, compensation circuitry and rugged aluminum housing assure continuous, reliable operation in industrial environments.

Accessories and customized configurations are available including electrical functions such as direction of rotation indication, measuring wheels, special shafts, and flexible couplings.

UNIDIRECTIONAL - RS Provides a single output (A) with the specified pulses per revolution regardless of which direction the shaft is rotating.

UNIDIRECTIONAL WITH INDEX - RSZ Second output (output Z) provides a zero reference or index pulse occurring once per revolution, having a pulse width approximately equal to a single pulse on output A.

QUADRATURE - RSQ Bidirectional encoder provides outputs A and B having the same number of pulses per revolution in quadrature relation to each other. Indicates shaft rotation and direction of rotation to any control device that accepts quadrature inputs.

QUADRATURE WITH INDEX - RSQZ Quadrature encoder with zero reference or index pulse.

DUAL OR TRIPLE OUTPUT - RS-a/b/c Provides two or three independent outputs with up to 360 pulses per revolution in place of the quadrature and index outputs.