

3 İletken, 4 Amper ve 30 Amper Kombinasyonu

Model 331

MODEL NO	İLETKENLER	TANIM	VOLTAJ AC/DC	240 VAC VOLTAJDA AMPER SINIFI	MAX FREKANS MHZ	TEMAS DİRENÇİ	MAX ÇALIŞMA RPM (dev/dak)	SICAKLIK MAX.F(C)/Min.F (C)	DEVİR TORK (gm/cm)	DEVRE KESİCİ
331	3	Standart Model	0-250	2@4/1@30	100	<1mΩ	1800	140(60)/-20(-29)	200	>25MΩ
331-SS	3	Paslanmaz Çelik Yataklı	0-250	2@4/1@30	100	<1mΩ	1800	140(60)/-20(-29)	200	>25MΩ

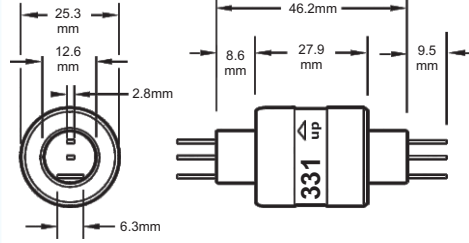

▼ Aksesuarlar



3 İletken, 30 Amper

Model 330 & 335

MODEL NO	İLETKENLER	TANIM	VOLTAJ AC/DC	240 VAC VOLTAJDA AMPER SINIFI	MAX FREKANS MHZ	TEMAS DİRENÇİ	MAX ÇALIŞMA RPM (dev/dak)	SICAKLIK MAX.F(C)/Min.F (C)	DEVİR TORK (gm/cm)	DEVRE KESİCİ
330	3	Standart Model	0-250	30	100	<1mΩ	1200	140(60)/-20(-29)	300	>25MΩ
330-SS	3	Paslanmaz Çelik Yataklı	0-250	30	100	<1mΩ	1200	140(60)/-20(-29)	300	>25MΩ
335	3	Yüksek Voltajlı Model	0-500	30	100	<1mΩ	500	140(60)/-20(-29)	700	>50MΩ
335-SS	3	Yüksek Voltaj Paslanmaz Çelik Yataklı	0-500	30	100	<1mΩ	500	140(60)/-20(-29)	700	>50MΩ



Yeni

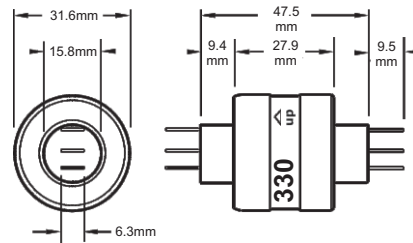

▼ Aksesuarlar



4 İletken, 4 Amper ve 30 Amper Kombinasyonu

Model 430

MODEL NO	İLETKENLER	TANIM	VOLTAJ AC/DC	240 VAC VOLTAJDA AMPER SINIFI	MAX FREKANS MHZ	TEMAS DİRENÇİ	MAX ÇALIŞMA RPM (dev/dak)	SICAKLIK MAX.F(C)/Min.F (C)	DEVİR TORK (gm/cm)	DEVRE KESİCİ
430	4	Standart Model	0-250	2@4/2@30	100	<1mΩ	1200	140(60)/-20(-29)	400	>25MΩ
430-SS	4	Paslanmaz Çelik Yataklı	0-250	2@4/2@30	100	<1mΩ	1200	140(60)/-20(-29)	400	>25MΩ

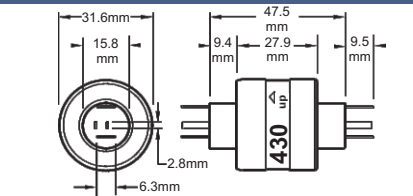

▼ Aksesuarlar

